

# Life Sciences: Seattle



## Market Highlights

- The RMR Group has finalized Unison Elliott Bay, a three-building redevelopment project in Seattle featuring 300,000 square feet (sf) of life sciences labs and research and development facilities.
- RareCyte raised \$20.0 million dollars to advance its applications in cell analysis.

**Vertex Pharmaceuticals has agreed to acquire Alpine Immune Sciences, a Seattle-based company specializing in innovative therapies targeting the immune synapse for treating cancer and autoimmune diseases, for \$4.9 billion.**

## Major Developments Under Construction



**1916 Boren**

- SF: 282,741
- Delivery: Q4 2024
- Developer: Trammell Crow and Washington Capital Management

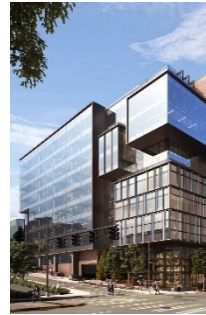

**701 Dexter**

- SF: 266,898
- Delivery: Q2 2025
- Developer: Alexandria Real Estate



**222 Fifth Avenue**

- SF: 197,919
- Delivery: Q3 2024
- Developer: Lincoln Property Company and Intercontinental Real Estate Corporation



**The Chapter Building II**

- SF: 158,521
- Delivery: Q3 2024
- Developer: Portman Holdings

## Notable Leases



**FUJIFILM SonoSite**

22011 30th Dr SE  
122,000 sf  
Q4 2023



**Immunome**

18702 N Creek Pkwy  
29,344 sf  
Q4 2023



**Taconic Biosciences**

1616 Eastlake Ave E  
15,004 sf  
Q2 2024



**Genoa Healthcare**

700 Dexter Ave N  
9,870 sf  
Q3 2023

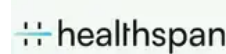

**Healthspan Technologies**

16398 NE 85th St  
1,167 sf  
Q1 2024

## Life Sciences Related VC Funding

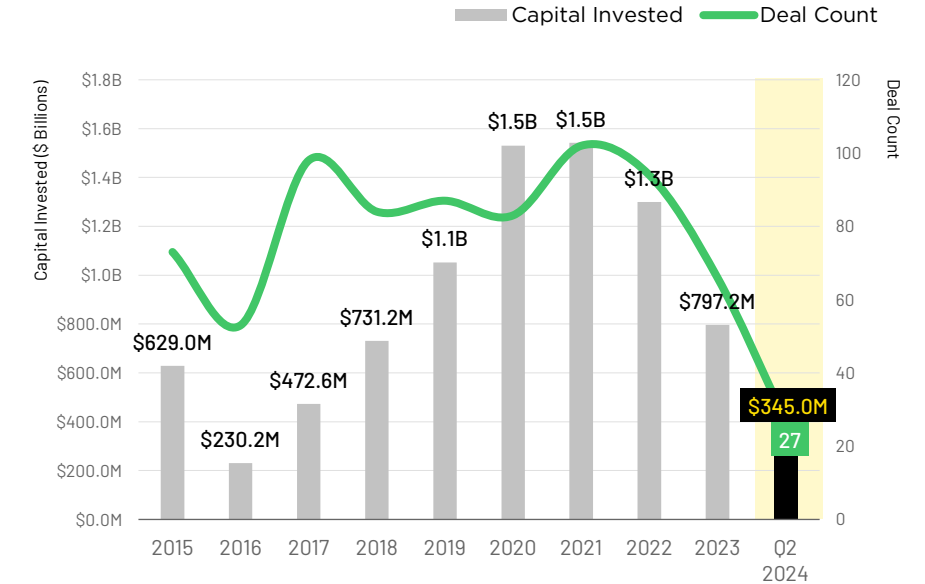

| Companies             | Deal Size | Deal Type      |
|-----------------------|-----------|----------------|
| RareCyte              | \$20.0M   | Later Stage VC |
| LumiThera             | \$8.1M    | Series C1      |
| Immusoft              | \$4.6M    | Series B       |
| Briotech              | \$2.0M    | Later Stage VC |
| NephroDI Therapeutics | \$2.0M    | Series A       |